

1	2	3	4	5	6			7	8
LUMINAIRE	HOOD	OPTICS	LAMP/BALLAST	DECORATIVE SCREEN	OPTIONS			COLOR	MOUNTING
					GENERAL	HOOD	SCREEN		
PKWS									



PAKWAY SQUARE
SMALL SCALE HOUSING



PKWS



PARKWAY SQUARE FAMILY OF FIXTURES



PKWM



PKWS



PKWB



PKSA/PKSP

Features

- Four optical systems, including horizontal, LED, vertical, and indirect
- Available with highly efficient LEDs
 - Available in IES Type 1, 3 or 5 distribution
 - Two standard color temperatures: 3500K or 5100K
- Three hood styles to configure a look in harmony with your architecture
- Six decorative screen options
- Wide variety of custom mounting options, including post-top, wall mount, or pole mount arm
- Custom 3" square pole perfectly complements luminaire styling
- Tool-less access
- Cast aluminum struts
- Full cutoff options
- EISA compliant
- IP65 rated for horizontal configurations and IP66 rated for vertical configurations
- Powder coat finish in 13 standard colors with a polymer primer sealer





JOB INFORMATION
TYPE
JOB NAME
LAMP (BY OTHERS)
CUSTOMER
DATE
<i>Consult factory for any custom/modified products</i>
APPROVALS

1	2	3	4	5	6			7	8
					OPTIONS				
LUMINAIRE	HOOD	OPTICS	LAMP/BALLAST	DECORATIVE SCREEN	GENERAL	HOOD	SCREEN		
PKWS									

1. LUMINAIRE

- PKWS Parkway Square Accent (Small) scale.
Slips over a 3" open top pole.

2. HOOD

- | | | | |
|--|--|---|--|
| <input type="checkbox"/> ANG
Angled Hood

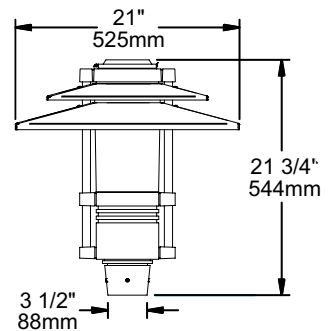
Horizontal Optics
HT: 23"/584 mm
DIA: 14"/356 mm
EPA: 1.68
WT: 34 lbs. | <input type="checkbox"/> IND
Indirect Hood
<i>(Underside finished in high reflectance white)</i>

Vertical Optics
HT: 21.75"/553 mm
DIA: 14"/356 mm
EPA: 1.46
WT: 44 lbs. | <input type="checkbox"/> STR
Straight Hood

Vertical Optics
HT: 21.75"/553 mm
DIA: 21"/533 mm
EPA: 1.52
WT: 45 lbs. | <input type="checkbox"/> DBL
Double Hood

Vertical Optics
HT: 21.75"/553 mm
DIA: 21"/533 mm
EPA: 1.56
WT: 46 lbs. |
|--|--|---|--|



3. OPTICS

HORIZONTAL LED OPTICAL SYSTEM – Available with ANG hood and LEDs only. Flat glass lens.

- | | |
|-----------------------------|---|
| <input type="checkbox"/> T1 | Horizontal LED optical system. IES Type 1 distribution. |
| <input type="checkbox"/> T3 | Horizontal LED optical system. IES Type 3 distribution. |
| <input type="checkbox"/> T5 | Horizontal LED optical system. IES Type 5 distribution. |

VERTICAL LED OPTICAL SYSTEM

- | | |
|------------------------------|------------------------|
| <input type="checkbox"/> GLA | Frosted glass diffuser |
|------------------------------|------------------------|

HORIZONTAL OPTICAL SYSTEM – Available with ANG hood only. Not available with LEDs. Flat glass lens.

- | | |
|-----------------------------|---|
| <input type="checkbox"/> H2 | Horizontal optical system. IES Type 2 distribution. |
| <input type="checkbox"/> H3 | Horizontal optical system. IES Type 3 distribution. |
| <input type="checkbox"/> H4 | Horizontal optical system. IES Type 4 distribution. |
| <input type="checkbox"/> H5 | Horizontal optical system. IES Type 5 distribution. |

VERTICAL OPTICAL SYSTEM – Not available with IND. Clear acrylic cylinder.

- | | |
|------------------------------|--|
| <input type="checkbox"/> GLA | Vertical optical system. Frosted glass diffuser. |
| <input type="checkbox"/> GR3 | Vertical optical system. IES Type 3 glass refractor. |
| <input type="checkbox"/> GR5 | Vertical optical system. IES Type 5 glass refractor. |

INDIRECT OPTICAL SYSTEM – Available with IND hood only. Not available with LEDs. Clear acrylic cylinder. Underside of hood is painted in high reflectance white.

- | | |
|-----------------------------|--|
| <input type="checkbox"/> -3 | Indirect reflector. IES Type 3 distribution. |
| <input type="checkbox"/> -5 | Indirect reflector. IES Type 5 distribution. |

BARE LAMP – Available with IL system only. Lightly diffused acrylic cylinder.

- | | |
|------------------------------|---|
| <input type="checkbox"/> BLO | Bare lamp system, only for induction lamp system. |
|------------------------------|---|

JOB INFORMATION
TYPE
JOB NAME
LAMP (BY OTHERS)
CUSTOMER
DATE
<i>Consult factory for any custom/modified products</i>
APPROVALS

1	2	3	4	5	6			7	8
LUMINAIRE	HOOD	OPTICS	LAMP/BALLAST	DECORATIVE SCREEN	OPTIONS			COLOR	MOUNTING
					GENERAL	HOOD	SCREEN		
PKWS									

4. LAMP/BALLAST

- 9LED-WW 9 light emitting diode array. Warm white (3500K). Class 2, 120 thru 277 volt. *GLA only.*
- 9LED-BW 9 light emitting diode array. Bright white (5100K). Class 2, 120 thru 277 volt. *GLA only.*
- 18LED-WW 18 light emitting diode array. Warm white (3500K). Class 2, 120 thru 277 volt. *GLA only.*
- 18LED-BW 18 light emitting diode array. Bright white (5100K). Class 2, 120 thru 277 volt. *GLA only.*
- 36LED-WW 36 light emitting diode array. 120 thru 277 volt. Warm white (3500K).
- 36LED-BW 36 light emitting diode array. 120 thru 277 volt. Bright white (5100K).
- 20MMC 20 watt electronic metal halide 120 thru 277 volt ballast. Use PGJ5 base, Mini MasterColor® lamp. Not available with horizontal or LED optics.
- 39MMC 39 watt electronic metal halide 120 thru 277 volt ballast. Use PGJ5 base, Mini MasterColor® lamp. Not available with horizontal or LED optics.
- 39MHT6EB 39 watt electronic metal halide 120 thru 277 volt ballast. Use G12 base, T6 ceramic lamp.
- 50MH 50 watt metal halide 120/208/240/277 volt ballast. Use medium base, ED-17 lamp. Not available with horizontal or LED optics.
- 70MH 70 watt metal halide 120/208/240/277 volt ballast. Use medium base, ED-17 lamp. Not available with horizontal or LED optics.
- 70MHT6 70 watt metal halide 120/277/347 volt ballast. Use G12 base, T6 ceramic lamp.
- 70MHEB 70 watt electronic metal halide 120 thru 277 volt ballast. Use medium base, ED-17 lamp. Not available with horizontal or LED optics.
- 70MHT6EB 70 watt electronic metal halide 120 thru 277 volt ballast. Use G12 base, T6 ceramic lamp.
- 50HPS 50 watt high pressure sodium 120/277 volt ballast. Use medium base, ED-17 lamp. Not available with horizontal or LED optics.
- 70HPS 70 watt high pressure sodium 120/208/240/277 volt ballast. Use medium base, ED-17 lamp. Not available with horizontal or LED optics.
- CF Compact fluorescent electronic 120 thru 277 volt ballast. Use GX24q base, 26, 32 or 42 watt lamp. Not available with horizontal or LED optics. -18° C min start temp. Specify wattage.
- IL55 55 watt induction lamp system. 120, 208, 240 or 277 volt. Available in bare lamp configuration (BLO) with LDL lens only.
- 60CO 60 watt electronic CosmoPolis™ 120 or 208 thru 277 volt ballast. Use PGZ12 base, CosmoPolis™ lamp. Not available with horizontal or LED optics.

All fixtures prewired for 277 volts unless specified. Lamps not included (except IL and LED options). All applicable ballasts are EISA compliant. Mini MasterColor® is a registered trademark and CosmoPolis™ is a trademark of Philips Lighting®.

JOB INFORMATION

TYPE

JOB NAME

LAMP (BY OTHERS)

CUSTOMER

DATE

Consult factory for any custom/modified products

APPROVALS



1	2	3	4	5	6			7	8
LUMINAIRE	HOOD	OPTICS	LAMP/BALLAST	DECORATIVE SCREEN	OPTIONS			COLOR	MOUNTING
					GENERAL	HOOD	SCREEN		
PKWS									

5. DECORATIVE SCREENS (OPTIONAL)

Painted to match fixture. Also available in stainless steel or copper. Not available with horizontal or LED optics.

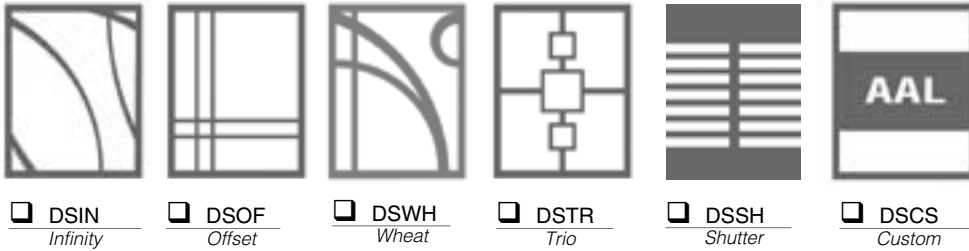

6. OPTIONS

GENERAL

- ULS Upper lens shield above the hood. Reduces light above hood.
- TEN 2 3/8" O.D. x 4" long tenon. Required for all poles, except for PS4. *GLA only.*
- TEN23 Tenon adaptor slips over a 2 3/8" O.D. x 4" long tenon. Required for poles by others or used in conjunction with the TEN pole option by AAL. *GLA only.*
- TEN3 3" O.D. x 3" long tenon. Required for all poles, except for PS3 and PR3.
- LDL Lightly diffused lens
- 347 120/240/347 volt ballast for HID only, except 50MH and 50HPS.

HOOD

- COP Brushed copper hood
- STS Stainless steel hood

DECORATIVE SCREEN

- SSP Screen in brushed stainless steel
- CPR Screen in brushed copper

7. COLOR

- | | |
|---|--|
| <input type="checkbox"/> AWT Arctic White | <input type="checkbox"/> MDG Medium Grey |
| <input type="checkbox"/> BLK Black | <input type="checkbox"/> ATG Antique Green |
| <input type="checkbox"/> MTB Matte Black | <input type="checkbox"/> LGY Light Grey |
| <input type="checkbox"/> DGN Dark Green | <input type="checkbox"/> SPP Salt and Pepper (premium) |
| <input type="checkbox"/> DBZ Dark Bronze | <input type="checkbox"/> SFM Seafoam (premium) |
| <input type="checkbox"/> WRZ Weathered Bronze | <input type="checkbox"/> WCP Weathered Copper (premium) |
| <input type="checkbox"/> BRM Metallic Bronze | <input type="checkbox"/> SHK Shamrock (premium) |
| <input type="checkbox"/> VBL Verde Blue | <input type="checkbox"/> RAL COLOR Provide a RAL 4 digit color number |
| <input type="checkbox"/> CRT Corten | <input type="checkbox"/> CUSTOM COLOR Please provide a color chip for matching |
| <input type="checkbox"/> MAL Matte Aluminum | |

JOB INFORMATION
TYPE
JOB NAME
LAMP (BY OTHERS)
CUSTOMER
DATE
<i>Consult factory for any custom/modified products</i>
APPROVALS

1	2	3	4	5	6			7	8
LUMINAIRE	HOOD	OPTICS	LAMP/BALLAST	DECORATIVE SCREEN	OPTIONS			COLOR	MOUNTING
					GENERAL	HOOD	SCREEN		
PKWS									

8. MOUNTING

WALL MOUNT – *Mounting plate included. Hardware by others.*

- PSWM-TU Fixture above with arm mounted up.
- PSWM-TD Fixture above with arm mounted down.
- PSWM-BU Fixture below with arm mounted up. Not available with indirect.
- PSWM-BD Fixture below with arm mounted down. Not available with indirect.

POLE MOUNT – *Mounts to the side of 4" O.D. pole.*

- PSA-TU Fixture above with arm mounted up.
- PSA-TD Fixture above with arm mounted down.
- PSA-BU Fixture below with arm mounted up. Not available with indirect.
- PSA-BD Fixture below with arm mounted down. Not available with indirect.



PSWM-TU
PSA-TU



PSWM-TD
PSA-TD



PSWM-BU
PSA-BU



PSWM-BD
PSA-BD

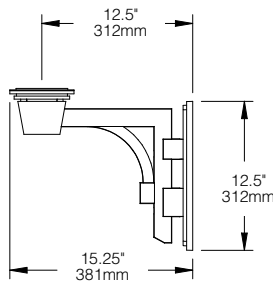
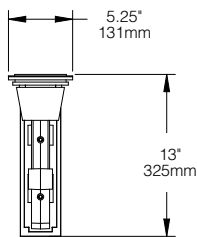

EPA: .45
WEIGHT: 8 lbs

JOB INFORMATION
TYPE
JOB NAME
LAMP (BY OTHERS)
CUSTOMER
DATE
<i>Consult factory for any custom/modified products</i>
APPROVALS

1	2	3	4	5	6			7	8
LUMINAIRE	HOOD	OPTICS	LAMP/BALLAST	DECORATIVE SCREEN	OPTIONS			COLOR	MOUNTING
					GENERAL	HOOD	SCREEN		
PKWS									

HOUSING

Parkway Square housings are cast aluminum, A356 alloy, free of any porosity, foreign materials, or cosmetic fillers. The ballast is mounted internally and accessed by loosening four captive bolts and lifting away the lamp compartment. One stainless steel latch shall release the door to allow access to the lamp. The lamp compartment is sealed with a molded silicone gasket. The reflector cone is matte finished aluminum. All lenses are molded, seamless high impact lighting grade acrylic. The lens is sealed to the housing with a molded silicone gasket on the top and bottom. The vertical struts are cast aluminum and painted to match the fixture. All internal and external hardware is stainless steel. The fixture shall slip over a 3"/76mm square post top and secured with four stainless steel set screws. The hood is formed from 5052 H32 aluminum, 304 stainless steel or 110 copper. For indirect models, the underside of the painted, copper, and stainless steel hoods are finished in a high reflectance white powder coating. Copper hoods are unfinished to develop a patina.

The horizontal reflector door shall be cast aluminum painted to match the fixture. The internal horizontal reflector module is sealed from the outer housing with a silicone gasket. The tempered glass lens shall be sealed to the housing with a silicone gasket. A pair of stainless steel latches shall release the door to allow access to the lamp. The reflector module shall be composed of faceted, specular and semi-specular anodized aluminum panels. The reflector assembly shall be removed by loosening four screws and lifting it out. The reflector tray shall be rotatable on 90° centers for orienting the light distribution. The horizontal lamp reflectors shall meet ANSI-IES standards for full cutoff reflector systems when using arm in the BU or BD configuration.

The GLA element is frosted borosilicate glass with a twist on connection to the lower cone assembly. The cone is matte finished anodized aluminum. The GR3 and GR5 are precision molded borosilicate glass refractors with a Type 3 or Type 5 distribution. The refractors are mounted to a gasketed aluminum holder with an internal pressure plate.

MICROEMITTER™

Precision injected molded, high specular reflectors are positioned to achieve directional control toward desired task. Secondary reflectors with a concave, specular medium hammertone finish are used to direct light downward. No fasteners are placed on the reflective surface. The entire assembly fastens to the housing as a one piece module and features wiring quick-connects for easy installation. Standard color temperatures for Nichia LEDs, NS6L183 and NS6W183 are 2500K and 5100K. MicroEmitters are field replaceable. 350mA drive current.

ELECTRICAL

The ballast shall be integral to the fixture mounted on a prewired module with a quick disconnect plug. The ballast module has two keyhole slots and is removable by loosening four screws. Sockets are pulse rated porcelain. HID ballasts are high power factor, rated for -30°C starting. The compact fluorescent ballast shall be electronic for use with 4 pin lamps (GX24q-4 socket) rated for -18° C starting temperature. Ballasts are wired at the factory for 277 volts, unless specified. The LED driver shall be integral to the fixture mounted on a prewired module with a quick disconnect plug. The driver module has two keyhole slots and is removable by loosening four screws. The driver shall accept 120 thru 277 volts input, with output drive current of 350ma. Standard color temperatures for LEDs shall be 3500k and 5100k. Rated luminous efficacy of luminaire shall be >40 lm/w, with rated light output of >1600 lumens for 5100k LED, standard mount.

INSTALLATION & MOUNTING

The PKWS shall be factory supplied as a complete, prewired assembly. The fixture shall slip over a 3"/75mm open top round pole or 4"/100mm pole mounted arm and secured and leveled with 4 stainless steel set screws.

FINISH

Fixture finish consists of a five stage pretreatment regimen with a polymer primer sealer, oven dry off and top coated with a thermoset super TGIC polyester powder coat finish. The finish shall meet the AAMA 605.2 performance specification which includes passing a 3000 hour salt spray test for corrosion resistance.

CERTIFICATION

The fixture is listed with ETL for outdoor, wet location use. Conforms to UL1598 and Canadian CSA Std. C22.2 no.9. IP66 rated for horizontal configurations and IP66 rated for vertical configurations.

WARRANTY

Fixture is warranted for three years, with the exception of Parkway Square LED models. Parkway Square LED, including housing, LEDs and electrical components are warranted for five years. Ballast and driver components carry the manufacturer's limited warranty. Any unauthorized return, repair, replacement or modification of the Product(s) shall void this warranty. This warranty applies only to the use of the Product(s) as intended by AAL and does not cover any misapplication or misuse of said Product(s), or installation in hazardous or corrosive environments. Contact AAL for complete warranty language, exceptions and limitations.

JOB INFORMATION

TYPE

JOB NAME

LAMP (BY OTHERS)

CUSTOMER

DATE

Consult factory for any custom/modified products

APPROVALS

