

Updated: 10/2009



NEW LED

TRD-DC

- Now available with highly efficient LED ring technology
 - Type 5 distribution pattern
 - Warm white (3500K) or bright white (5100K)
- Round, square, or pedestal models available
- Three grill design options to address application requirements
- Body and caps are composed of precast concrete reinforced with an internal cage structure of steel
- Grills are cast aluminum with stainless steel hardware
- Inner lens is sealed to the grill frame
- EISA compliant
- IP54 rated
- Color of grills available in 13 standard colors with a polymer primer sealer



TPR-OL



TSQ-DC

Architectural Area Lighting

16555 East Gale Ave. City of Industry | CA 91745

T 626.968.5666 | F 626.369.2695 | www.aal.net

Copyright © 2009 Rev 10/2009

Design patents D425,173 S; D426,013 S; D435,130 S; D435,309 S; D439,000 S; D440,339 S



Fixture	Lamp/Ballast	Options	Grill Color
TRD-DC	36LED-WW	90S	BLK

FIXTURE

Round Pedestal

- TPR-OL Opal acrylic lens - Wt: 46 lbs

- TPR-DC Decorative cast grill, opal acrylic lens - Wt: 46 lbs

- TPR-VR Vandal resistant cast grill, opal acrylic lens - Wt: 46 lbs

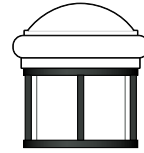

TPR-OL

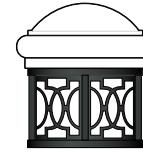

TPR-DC

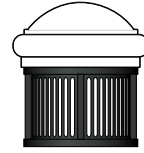

TPR-VR

Square Pedestal

- TPS-OL Opal acrylic lens - Wt: 46 lbs

- TPS-DC Decorative cast grill, opal acrylic lens - Wt: 46 lbs

- TPS-VR Vandal resistant cast grill, opal acrylic lens - Wt: 46 lbs

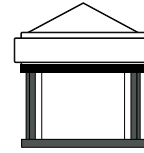

TPS-OL

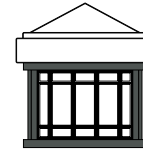

TPS-DC

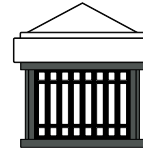

TPS-VR

Round Bollard

- TRD-OL Opal acrylic lens - Wt: 323 lbs

- TRD-DC Decorative cast grill,
opal acrylic lens - Wt: 323 lbs

- TRD-VR Vandal resistant cast grill,
opal acrylic lens - Wt: 323 lbs

- TRD-UN Unlit bollard with no cast grill section- Wt: 309 lbs

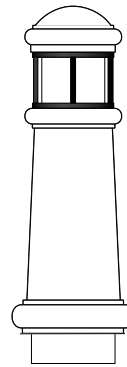

TRD-OL

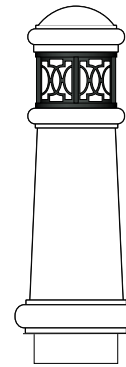

TRD-DC

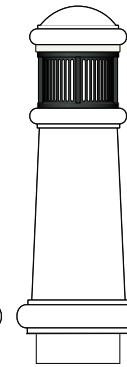

TRD-VR

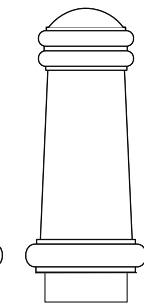

TRD-UN

Square Bollard

- TSQ-OL Opal acrylic lens - Wt: 271 lbs

- TSQ-DC Decorative cast grill,
opal acrylic lens - Wt: 271 lbs

- TSQ-VR Vandal resistant cast grill,
opal acrylic lens - Wt: 271 lbs

- TSQ-UN Unlit bollard with no cast grill section- Wt: 257 lbs

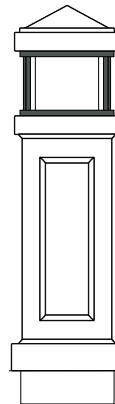

TSQ-OL

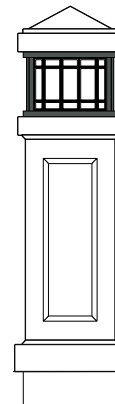

TSQ-DC

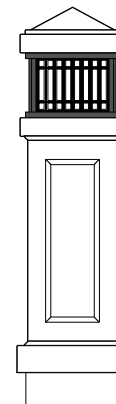

TSQ-VR

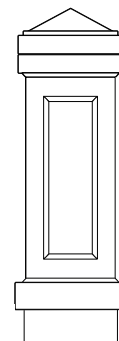

TSQ-UN

Opal acrylic lens is lightly sandblasted when LED option is chosen.

See page 4 for product dimensions

SOLD TO	PO #	JOB NAME
---------	------	----------

Approvals

Architectural Area Lighting

16555 East Gale Ave. City of Industry | CA 91745

T 626.968.5666 | F 626.369.2695 | www.aal.net

Copyright © 2009 Rev 10/2009

Design patents D425,173 S; D426,013 S; D435,130 S; D435,309 S; D439,000 S; D440,339 S

Fixture	Lamp/Ballast	Options	Grill Color
TRD-DC	36LED-WW	90S	BLK

LAMP/BALLAST

- CF Compact fluorescent, electronic 120 thru 277 volt ballast. Use 4-pin, 26, 32 or 42 watt T-4 lamps. -18°C min. starting temperature.

 - 50MH 50 watt metal halide 120/208/240/277 volt ballast. Use medium base, ED-17 lamp.
 - 70MH 70 watt metal halide 120/208/240/277 volt ballast. Use medium base, ED-17 lamp.
 - 70MHT6 70 watt metal halide 120/277/347 volt ballast. Use G12 base, T-6 ceramic lamp.
 - 100MH 100 watt metal halide 120/208/240/277 volt ballast. Use medium base, ED-17 lamp.
 - 50HPS 50 watt high pressure sodium 120/277 volt ballast. Use medium base, ED-17 lamp.
 - 70HPS 70 watt high pressure sodium 120/208/240/277 volt ballast. Use medium base, ED-17 lamp.
 - 100HPS 100 watt high pressure sodium 120/208/240/277 volt ballast. Use medium base, ED-17 lamp.
 - IL-55 55 watt induction lamp system. Specify 120, 208, 240, or 277 volt ballast.
 - IL-85 85 watt induction lamp. Specify 120, 208, 240, or 277 volt ballast.
 - 36LED-WW 36 light emitting diode array (37 watt). Warm white (3500K). IES Type 5. 120 thru 277 volt.
 - 36LED-BW 36 light emitting diode array (37 watt). Bright white (5100K). IES Type 5. 120 thru 277 volt.
- Lamps not included (except LED and IL options). All fixtures prewired for 277 volts, unless specified. All applicable ballasts are EISA compliant.*

OPTIONS

- 90S 90 degree shield, field installed

- 180S 180 degree shield, field installed

- QRS Quartz restrike controller and socket for a T4 mini-can halogen lamp, HID version only. QRS lamp wattage not to exceed primary lamp wattage. **Not available with induction or LED.**

- QL Socket for a T4 mini-can halogen lamp must be field wired to a separate 120 volt, HID version only. QL lamp wattage not to exceed primary lamp wattage. **Not available with induction or LED.**

- 347 120/277/347 volt HID ballast for 70MH, 100MH, 70HPS and 100HPS only. 347 volt for 50MH and 50HPS only. **Not available with induction or LED.**

GRILL COLOR

- | | |
|---|--|
| <input type="checkbox"/> AWT Arctic White | <input type="checkbox"/> CRT Corten |
| <input type="checkbox"/> BLK Black | <input type="checkbox"/> MAL Matte Aluminum |
| <input type="checkbox"/> MTB Matte Black | <input type="checkbox"/> MDG Medium Grey |
| <input type="checkbox"/> DGN Dark Green | <input type="checkbox"/> ATG Antique Green |
| <input type="checkbox"/> DBZ Dark Bronze | <input type="checkbox"/> LGY Light Grey |
| <input type="checkbox"/> WRZ Weathered Bronze | <input type="checkbox"/> RAL/PREMIUM COLOR Provide a RAL 4 digit color number |
| <input type="checkbox"/> BRM Metallic Bronze | <input type="checkbox"/> CUSTOM COLOR Please provide a color chip for matching |
| <input type="checkbox"/> VBL Verde Blue | |

			Approvals
--	--	--	-----------

Architectural Area Lighting

16555 East Gale Ave. City of Industry | CA 91745

T 626.968.5666 | F 626.369.2695 | www.aal.net

Copyright © 2009 Rev 10/2009

Design patents D425,173 S; D426,013 S; D435,130 S; D435,309 S; D439,000 S; D440,339 S

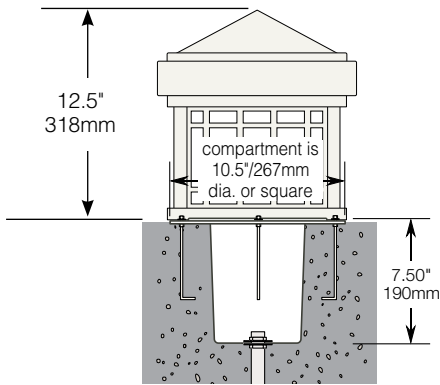

Pedestal bollard



The ballast compartment can be set in a poured-in-place concrete pad.

Bolt circle of ballast compartment anchor bolts is 9.25"/235mm diameter.

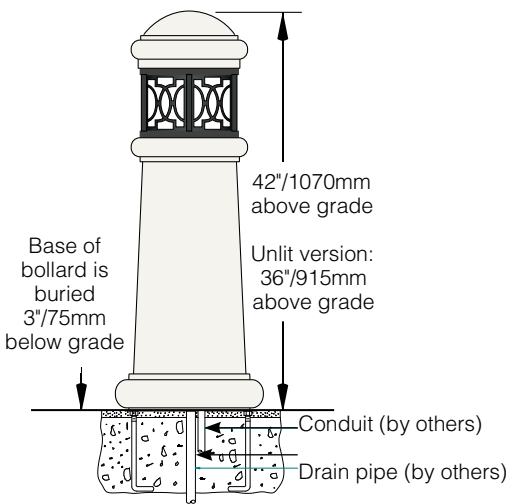

Round bollard

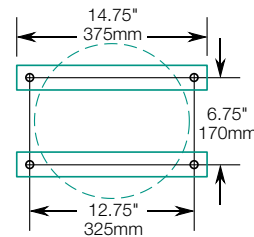

Bollard at base is 12"/305mm round. Mounting holes are .87"/22mm diameter. The four (4) anchor bolts (10"/254mm long), washers and nuts supplied are hot dipped galvanized.

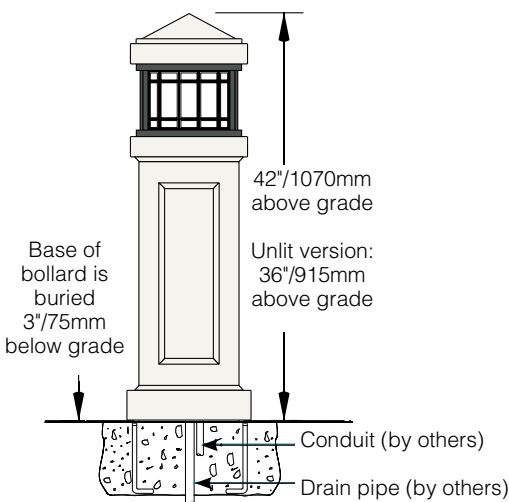

Square bollard

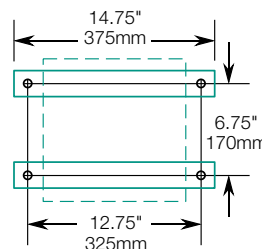

Bollard at base is 10"/254mm square. Mounting holes are .87"/22mm diameter. The four (4) anchor bolts (10"/254mm long), washers and nuts supplied are hot dipped galvanized.

NOTE: Concrete is always pre-paid and added.

SOLD TO

PO #

JOB NAME

Approvals

Architectural Area Lighting

16555 East Gale Ave. City of Industry | CA 91745

T 626.968.5666 | F 626.369.2695 | www.aal.net

Copyright © 2009 Rev 10/2009

Design patents D425,173 S; D426,013 S; D435,130 S; D435,309 S; D439,000 S; D440,339 S

Specifications

CONCRETE BODY AND CAP

The body and caps are composed of precast concrete reinforced with an internal cage structure of steel. The concrete bodies are one-piece castings with a minimum wall thickness of 2 1/4". All threaded inserts are welded to the steel reinforcing cage and cast in place. The base plate for anchoring is 1/4" hot dipped galvanized steel. Bollards are not rated for traffic barrier application.

GRILL

Grills are cast aluminum, minimum wall thickness of .250". All castings are pure aluminum #356 alloy, free of any foreign material or porosity. Grills have cast-in-place, integral mounting lugs for attachment to the concrete base. The lens is one-piece, seamless opal acrylic. Lens is lightly sandblasted when LED option is chosen. The lens is sealed at both ends with a molded silicone gasket. The grill assembly is sealed to the concrete with a silicone compression gasket on the top and bottom for weather tight operation. Recessed stainless steel screws are loosened to remove the top cap for relamping.

FINISH

Standard concrete color is Lehigh white with a light sandblast finish. No custom color is available.

Grill finish consists of a five stage pretreatment regimen with a polymer primer sealer, oven dry off and top coated with a thermoset super TGIC polyester powder coat finish. The finish shall meet the AAMA 605.2 performance specification which includes passing a 3000 hour salt spray test for corrosion resistance.

ELECTRICAL MODULE

The electrical module consists of the ballast module and lamp housing. All housing parts are aluminum with stainless steel hardware. The ballast module is prewired on an aluminum strap mounted to the underside of the lamp housing. The electrical module is silicone gasketed for weather tight operation. The pedestal version(s) shall include an aluminum ballast enclosure for use in a field constructed base. HID ballasts are high power factor, rated for -30°C minimum starting temperature. Ballasts are wired at the factory for 277 volts, unless specified. Compact fluorescent transformers are electronic, 120 thru 277 volt for 26, 32 or 42 watt 4 pin lamps. LED components are 120 thru 277 volt. LED constant current driver operates at 350mA.

EISA COMPLIANCE

AAL is committed to complying with U.S. EISA requirements. All applicable products manufactured for sale in the United States after January 1, 2009, meet EISA requirements.

CERTIFICATION

All bollards shall be listed with ETL for outdoor, wet location use, UL1598 and Canadian CSA Std. C22.2 no.250. IP=55.

WARRANTY

Fixture is warranted for three years. Ballast components carry the ballast manufacturer's limited warranty. Any unauthorized return, repair, replacement or modification of the Product(s) shall void this warranty. This warranty applies only to the use of the Product(s) as intended by AAL and does not cover any misapplication or misuse of said Product(s), or installation in hazardous or corrosive environments. Contact AAL for complete warranty language, exceptions, and limitations.

Architectural Area Lighting

16555 East Gale Ave. City of Industry | CA 91745

T 626.968.5666 | F 626.369.2695 | www.aal.net

Copyright © 2009 Rev 10/2009

Design patents D425,173 S; D426,013 S; D435,130 S; D435,309 S; D439,000 S; D440,339 S